

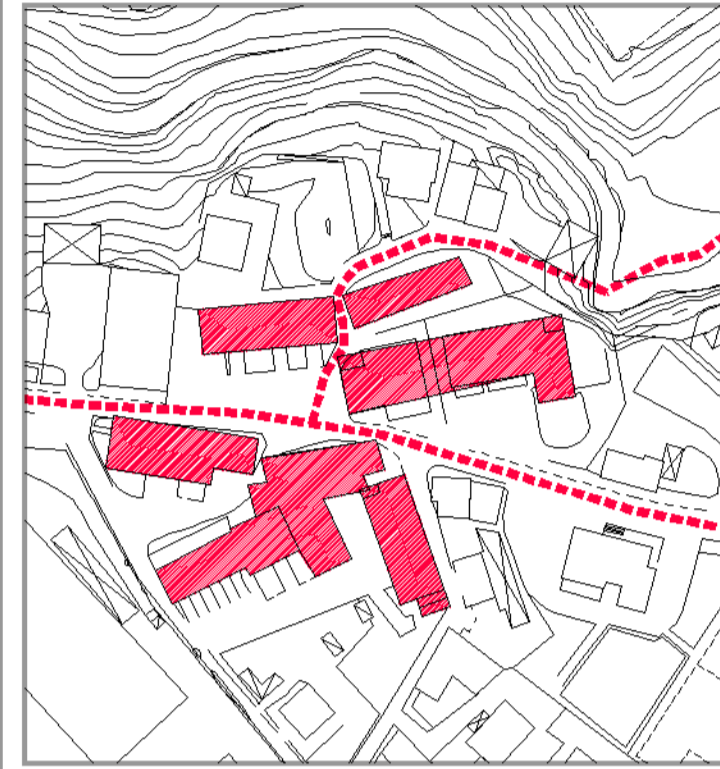

Catasto Teresiano - 1722

Catasto Cessato - 1860/1898



Cartografia IGM - 1936

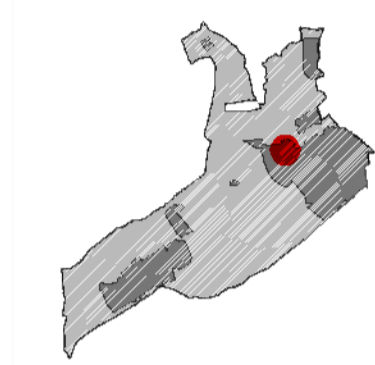

NUCLEO DI SENNA COMASCO



Catasto Teresiano - 1722

Catasto Cessato - 1860/1898

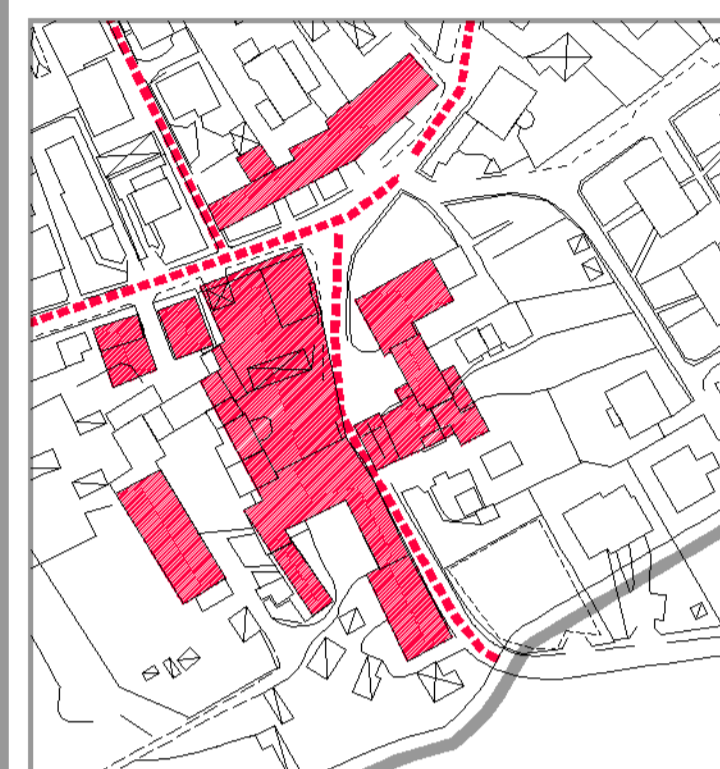

Cartografia IGM - 1936



NUCLEO DI NAVEDANO

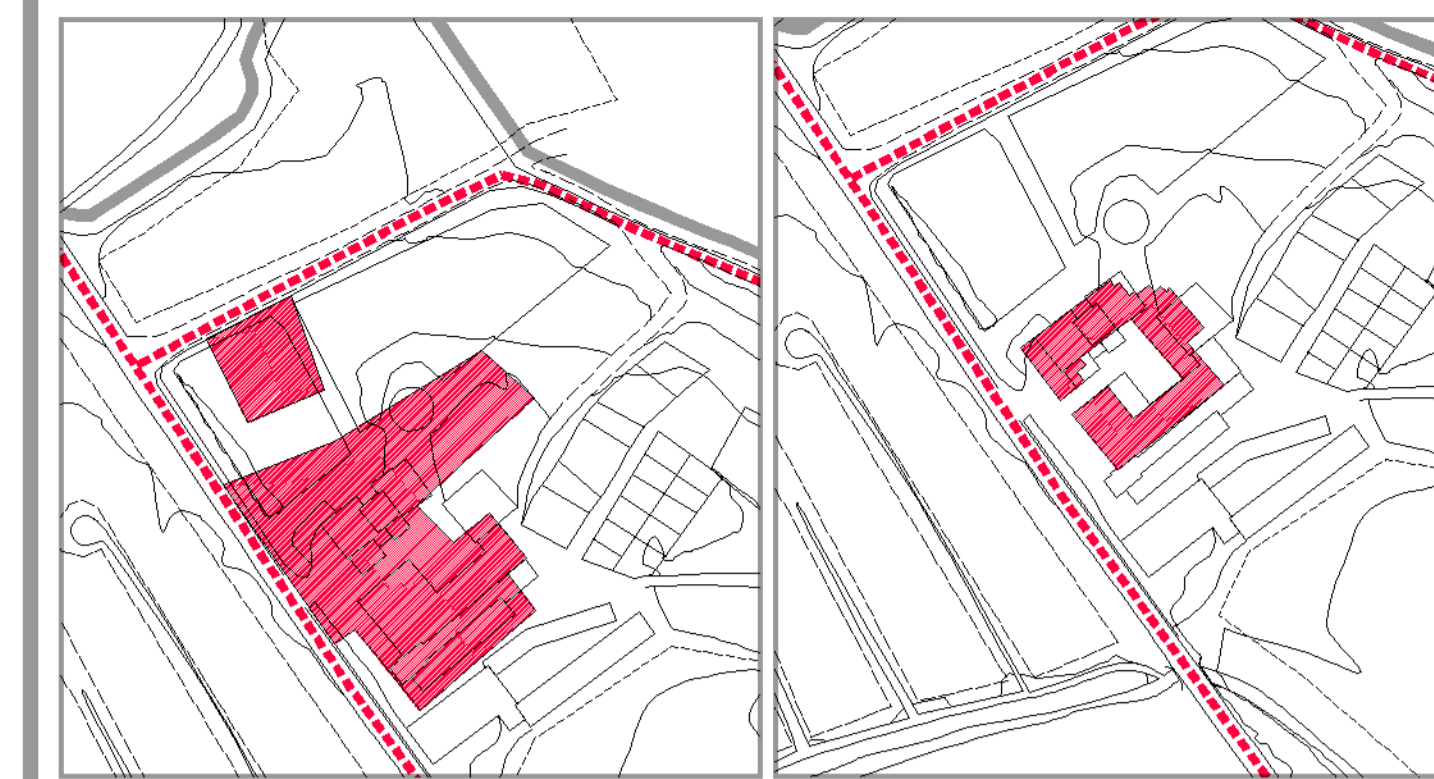

Catasto Teresiano - 1722

Catasto Cessato - 1860/1898

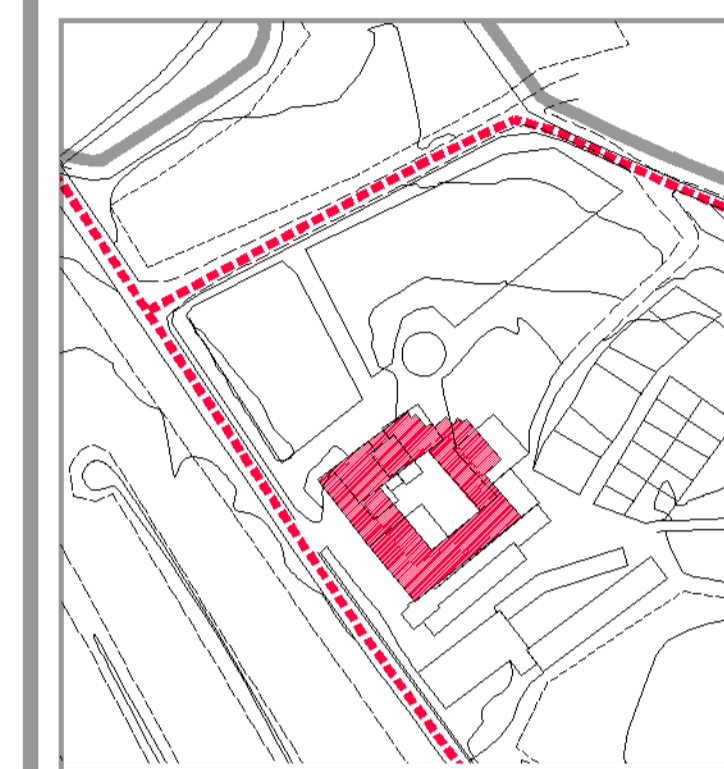

Cartografia IGM - 1936

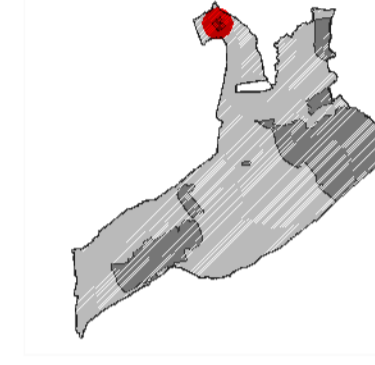

CASCINA BASSONE



Catasto Teresiano - 1722

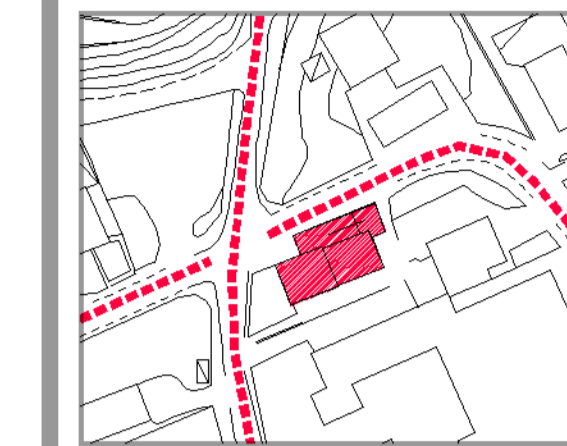

Catasto Cessato - 1860/1898

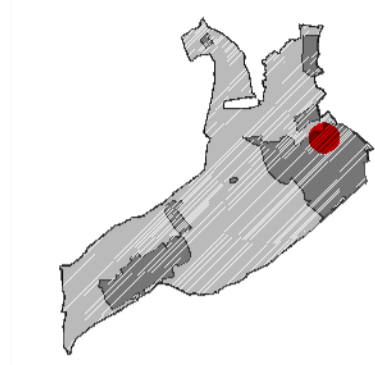

Cartografia IGM - 1936



CHIESA DI SANTA MARIA ASSUNTA

 Tessuto urbano esistente alla soglia di riferimento
 Viabilità esistente alla soglia di riferimento

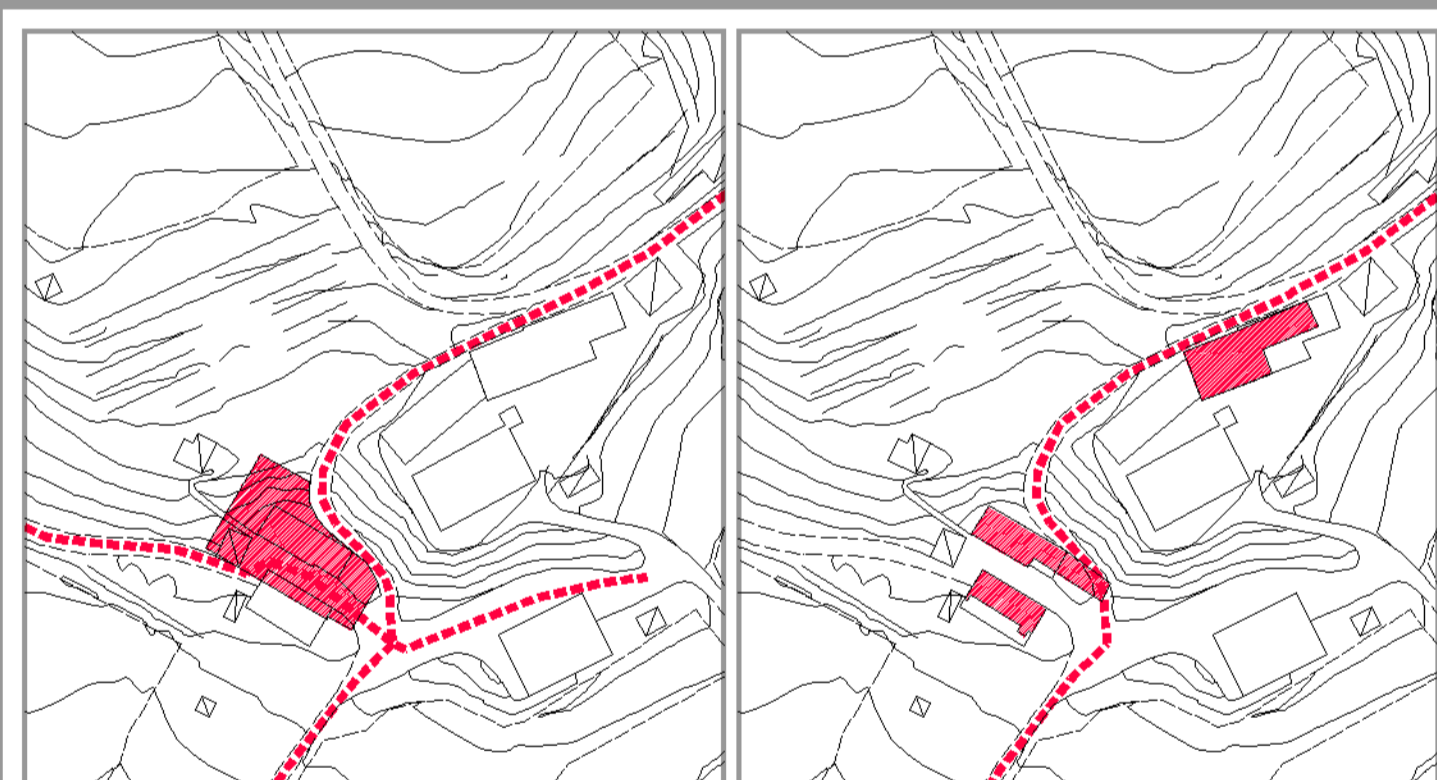

Catasto Teresiano - 1722

Catasto Cessato - 1860/1898

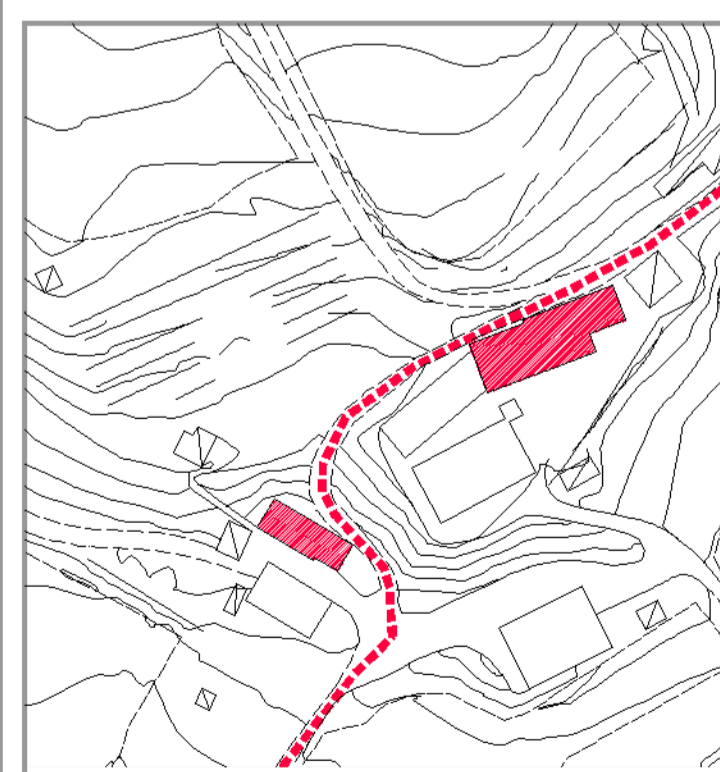

Cartografia IGM - 1936

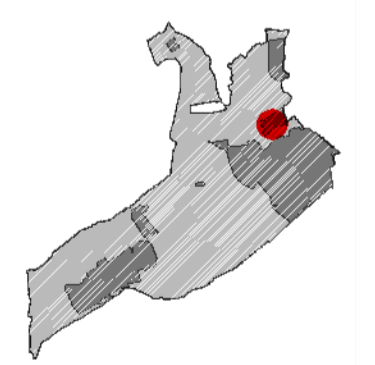

CASCINA MOTTA



Catasto Teresiano - 1722

Catasto Cessato - 1860/1898

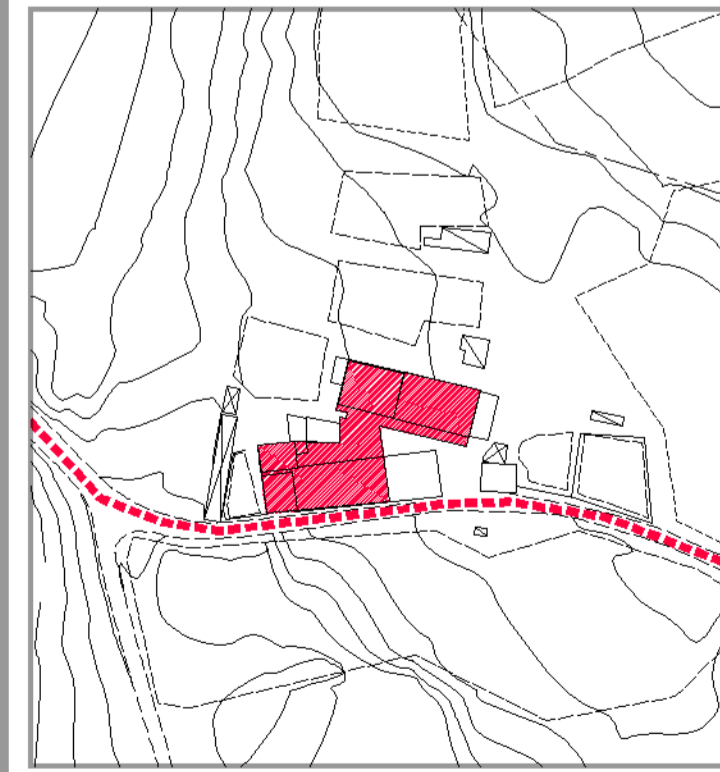

Cartografia IGM - 1936

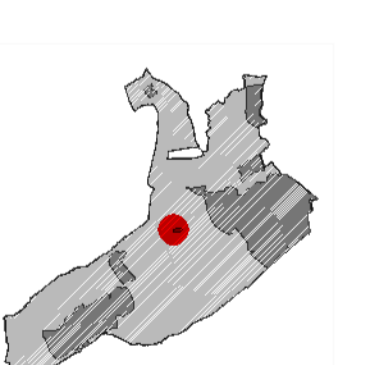

CASCINA GAGGIO

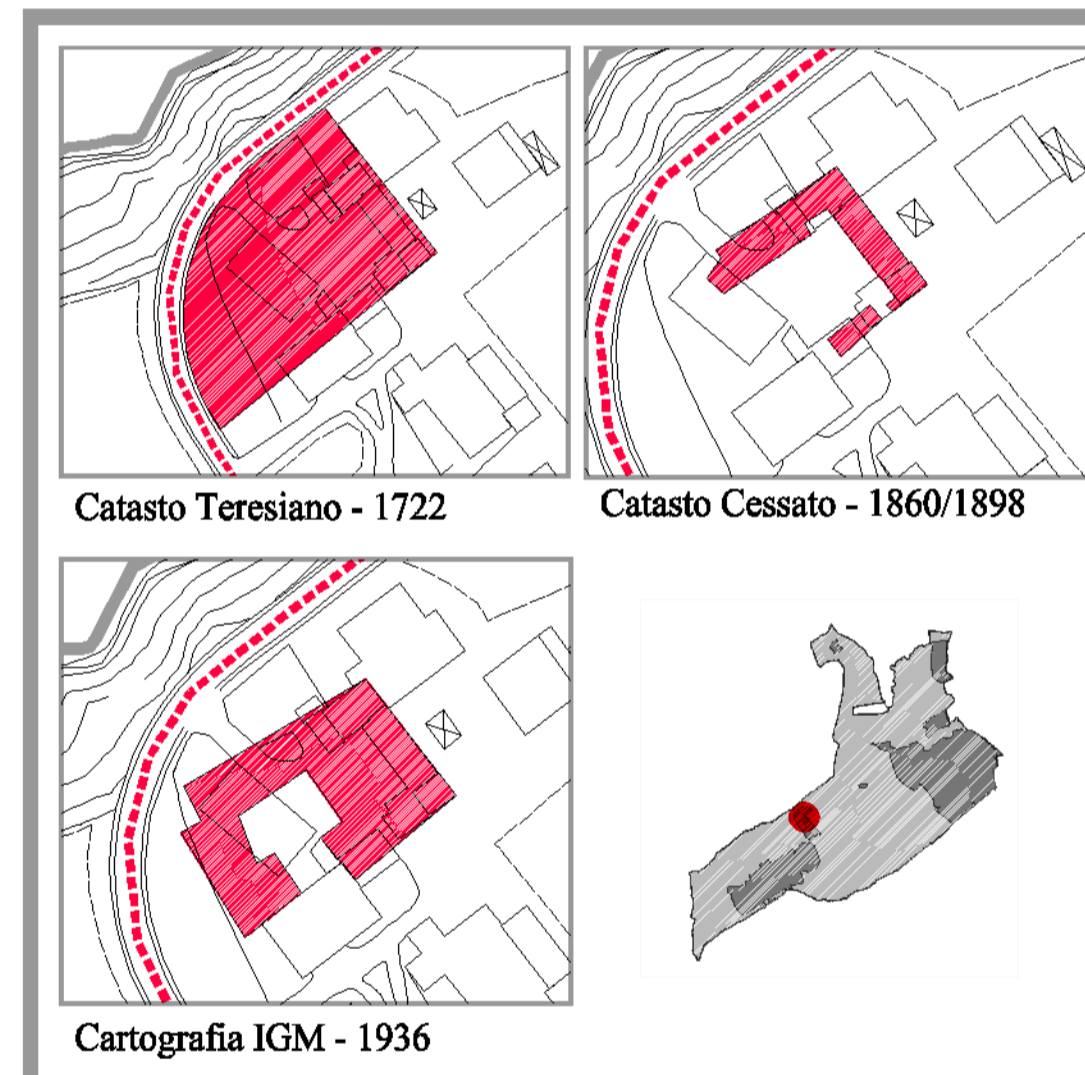

Catasto Teresiano - 1722

Catasto Cessato - 1860/1898

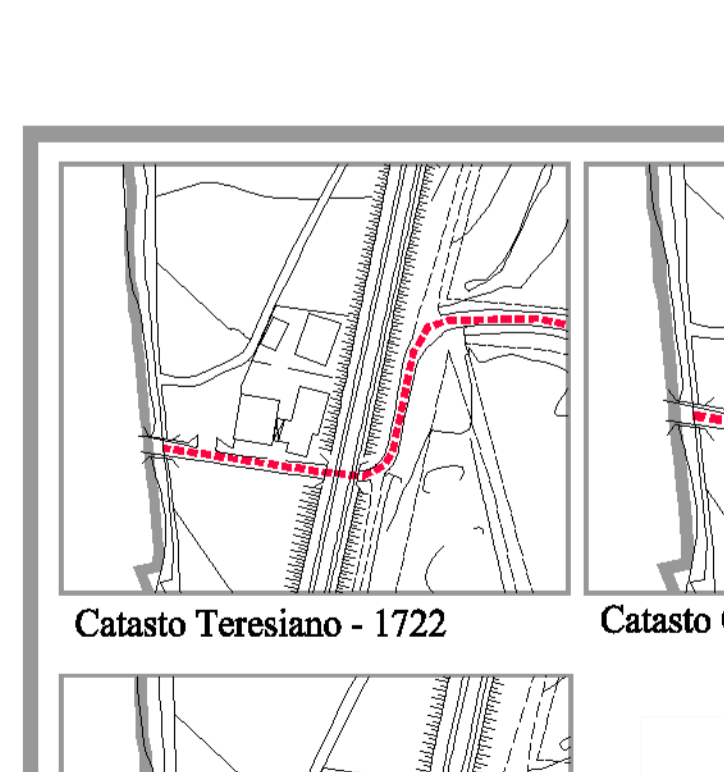

Cartografia IGM - 1936

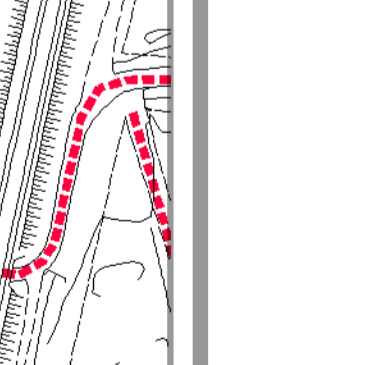

CASCINA BETTINA

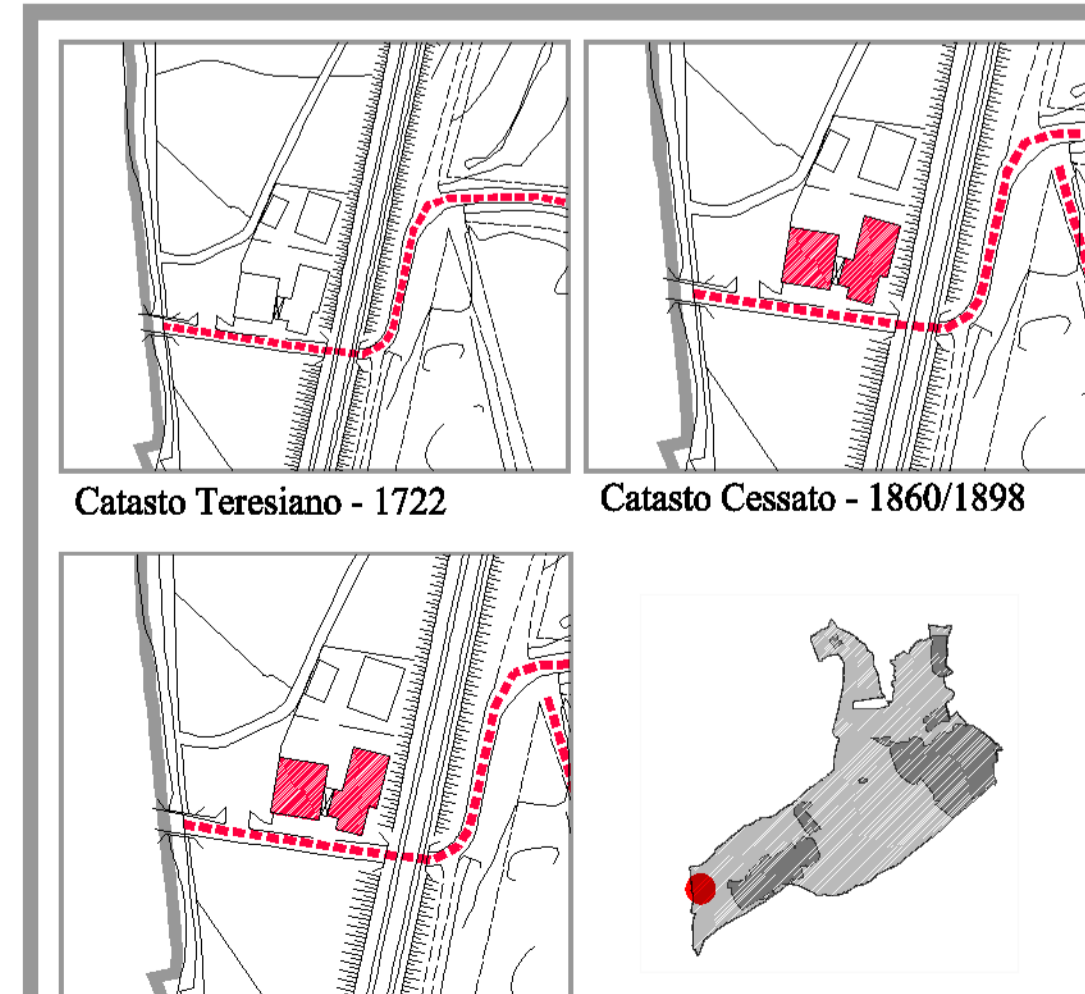

Cartografia IGM - 1936

MOLINO VIA CASNATE

 <p>COMUNE DI SENNA COMASCO PROVINCIA DI COMO</p>		<p>PIANO DI GOVERNO DEL TERRITORIO</p>	
<p>ADOZIONI: Delibera C.C. n° 9 del 06/03/2008</p>		<p>AGGIORNAMENTO IN ACCOGLIMENTO DI: - Osservazioni - Valutazione di compatibilità provinciale</p>	
<p>PUBBLICAZIONE: del 19/03/2008</p>		<p>del 18/04/2008</p>	
<p>COMPATIBILITÀ A.P. n° 17/06/09</p>		<p>del 22/07/2008</p>	
<p>APPROVAZIONE: Delibera C.C. n°</p>		<p>del</p>	
<p>IL COMMISSARIO STRAORDINARIO Dott. Nicola Ventura</p>			
<p>IL RESPONSABILE DELL'AREA TECNICA Arch. Luciano Arcelladi</p>			
<p>PROGETTISTA:  STUDIO R&L INGEGNERI ARCHITETTI Viale Matteotti n. 1/2C 22012 - Comabbio (CO) Telefono: 031-234702 Telefono: 031-3347027</p>		<p>QUADRO CONOSCITIVO SISTEMA DEL CONSOLIDATO DI MATRICE STORICA</p> <p>AREE E BENI DI PARTICOLARE RILEVANZA EVOLUZIONE STORICA 1722 - Catasto Teresiano 1860-98 - Catasto Cessato 1936 - I.G.M.</p>	
<p>COLLABORATORE: Arch. Guido M. Polli Dott. Luca Della Piovra</p>		<p>ELABORATO 15.a</p>	
<p>SCALA: 1/2000</p>			
<p>TERRITORIO PRINCIPALE 1722-1860-1936-1936</p>		<p>RELAZIONE 1936-1936-1936-1936</p>	
<p>RELAZIONE 1722-1860-1936-1936</p>		<p>RELAZIONE 1722-1860-1936-1936</p>	