









PLANIMETRIA

Stato di fatto

LEGENDA:

	perimetro P.L.U.
	perimetro Lotti A...O
	accesso carrabile
	ingressi pedonali
	fabbricati esistenti
	asfalto (binder)
	area a verde privato
	area a verde pubblico

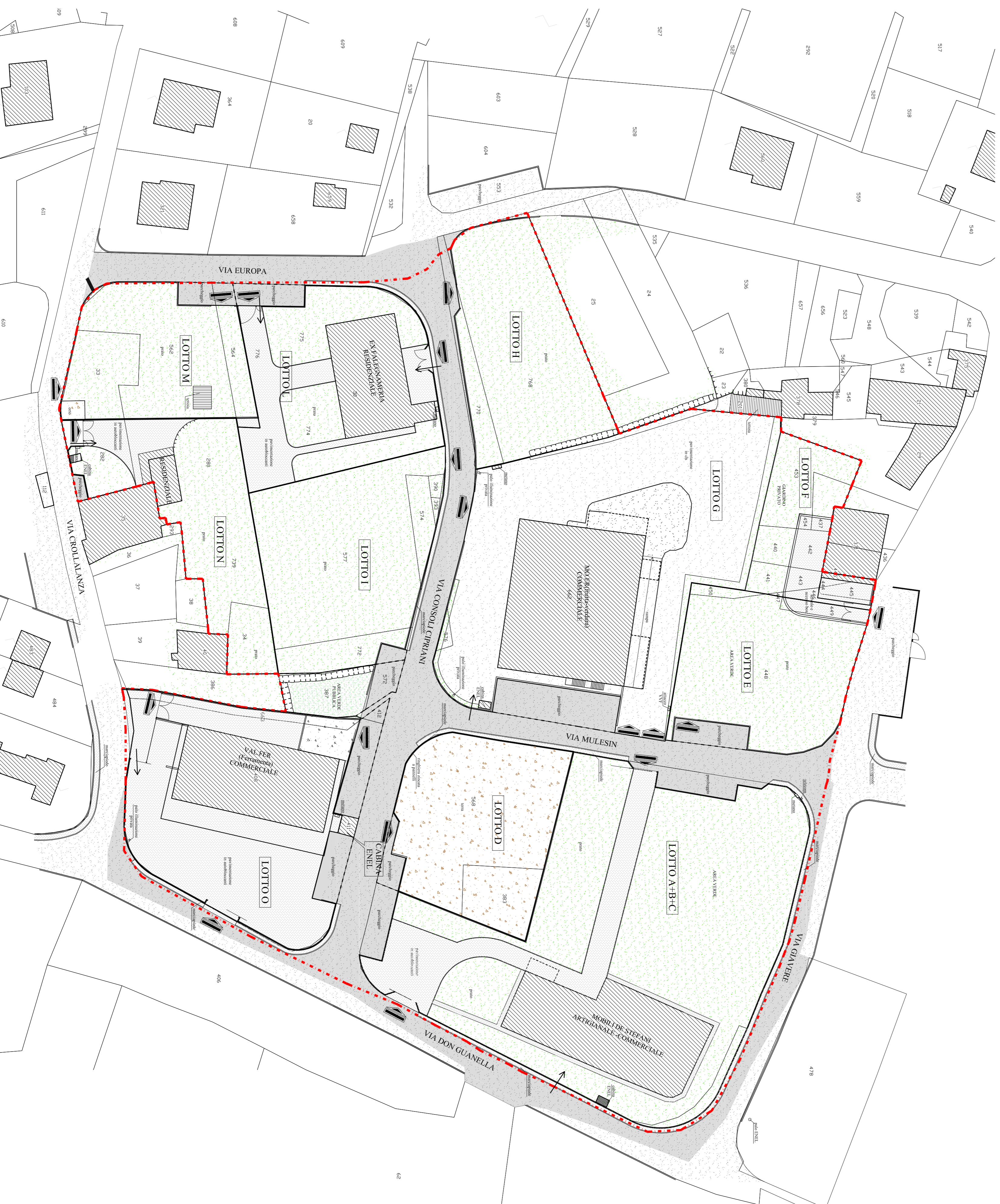

Comune di MESE

Provincia di SONDRIO



P.L.U. - Loc. CROLLALANZA

Revisione 2018

DATA dicembre 2018	TAV. 2
AGGIORNAMENTO PLANIMETRIA-STATO DI FATTO	SCALA 1:500

PROPRIETA': *Comune di MESE*

PROGETTISTA

STUDIO GERONIMI ASSOCIATO

Dott. Ing. Piergiorgio Geronimi
Dott. Ing. Nicola Geronimi
C.F. - P. IVA 00942100141
23020 Chiesano (SO)
Via Zanone 30
Tel./fax 0343 33 333
info@studiogeronomi.it

Esat.: 69_18 P.L.U.

OGNI RIPRODUZIONE DEL PRESENTE DISSEGNO E' VIETATA E TUTTI I DIRITTI D'AUTORE SONO RISERVATI A TERME DI LEGGE